

## V28F4 STAND ASSEMBLY INSTRUCTIONS

CODE	PART	QTY	CODE	PART	QTY
<b>BAGGED KIT</b>			<b>FIXTURE PARTS</b>		
<b>BC</b>	Black caps	4	<b>A</b>	Adaptor	8
<b>N</b>	Nuts	8	<b>SP</b>	Spacer	8
<b>GC</b>	Ground cord	1	<b>FN</b>	Flat Nut	8
<b>SC</b>	Screws	20	<b>K</b>	Knob with stud	8
<b>C</b>	Screw cover	8	<b>F</b>	Fixture	4
				Lamps	8
<b>DW</b>	Domed washer	24	(16 used for fixture assembly)		
			<b>STAND PARTS</b>		
<b>R</b>	Slide rods	4			
<b>S</b>	Short pieces with 2 holes	2			
<b>L</b>	Shelf supports	4			
<b>E</b>	Endframes	2			

### Stand Assembly

- Assemble short pieces **S** between bottom of endframe **E**, using the screws **SC**, keeping all holes facing the same direction (**outside to inside**--not up to down). Repeat this step on other endframe **E**.
- Insert a screw **SC** in one of the top holes of endframe **E** from the outside. Hang a slide rod **R** over screw, (rods on the **inside** of the stand). Install a domed washer **DW** on screw. Screw on a nut **N**, and tighten. Place a screw cover **C** on the end of screw.
- Insert a screw **SC** in one of the holes in the short piece **C** from the outside, between the bottom ends of slide rod **R**. Install a domed washer **DW**. Screw on a nut **N**, and tighten. Place a screw cover **C** on the end of the screw. Repeat steps **2-3** for other rods **R**.
- Place black caps **BC**, in the bottom of the endframes **E**.
- Place a screw **SC** through the hole of the endframe **E**, and then into the end of the shelf support **L**, making sure the shelf support **L** is on the same side as the slide rods **R**, (**the rods should be on the inside of the unit when finished**), and tighten. Repeat this step for the rest of the shelf supports **L**.
- Place plant trays **T** on the shelves.

### Fixture Assembly (refer to Fixture Mounting Detail)

**Caution:** When removing fixtures from box, make sure lamps are on top, so they don't fall out.

- Install lamps into fixture **F**, without sleeves. Place fixture **F** on trays **T**, lamps down, between rods **R**.
- Slide adaptor **A** into end cap of fixture, as shown. Slide flat nut **FN**, on top of adaptor **A**, with threads to middle of fixture.
- Place a domed washer **DW** on knob **K**, with dome next to knob, insert knob threads through rods **R**. Place another domed washer **DW** on threads, in opposite direction to first one. Place spacer **SP** on stud.
- Thread stud into flat nut **FN**, and tighten until domed washers **DW** seat on rods.
- Repeat steps **2** to **4** on other end of fixture **F**.
- Loosen knobs to adjust height of fixture, not over 6" at a time at each end, until desired height is obtained. Tighten knobs.

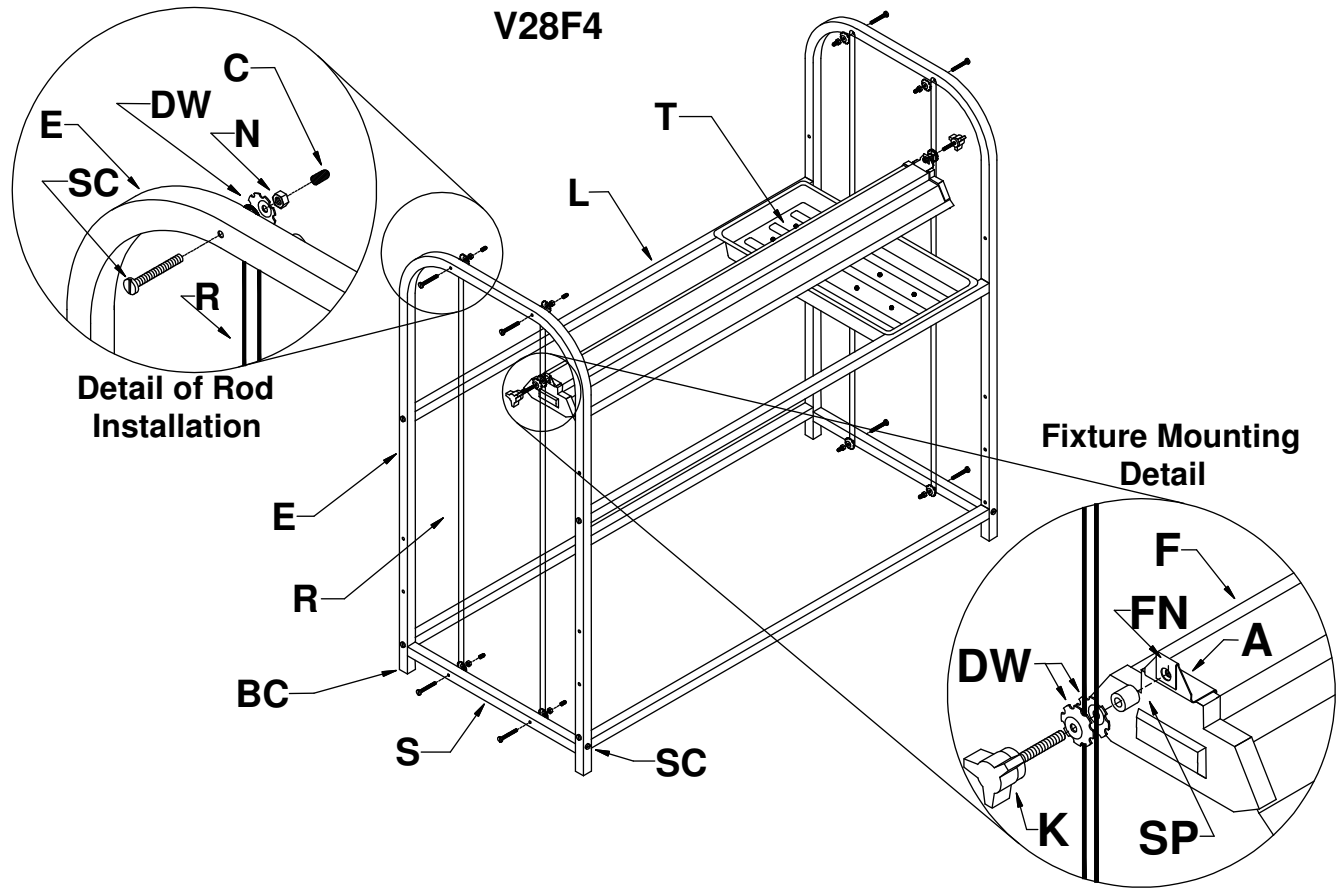

CODE	PART
A	ADAPTOR
BC	BLACK CAPS
DW	DOMED WASHER
E	END FRAME
F	FIXTURE
FN	FLAT NUT
K	KNOB WITH STUD
L	SHELF SUPPORT
R	SLIDE ROD
S	SHORT PIECE WITH 2 HOLES
SC	SCREW
SP	SPACER
T	PLANT TRAY

**To Prevent Electrical Shock: Connect the eyelet of the enclosed ground cord to any bolt head. The other end should be connected to a ground point such as a water pipe or center screw of a grounded outlet. Please disconnect fixtures when watering plants.**